



Public Internet Access Done the Right Way

- Supports 500 concurrent logins by default and up to 800 via license upgrade
- Integrated account generator, Web-based authentication portal and billing system
- Supports up to ten (10) SP350E Service Gateway Printers and SMS ticketing with ViaNett protocol
- Per account bandwidth management
- Dual-WAN load-balancing, failover and fall back support
- Built-in WLAN controller (supports 16 APs by default and up to 32 APs via license upgrade)
- Facilitates compliance with data retention regulations
- Provides ten (10) IPSec VPN tunnels for remote management by MSPs

Providing Internet access in public areas is not the same as providing Internet access in homes or offices. Public Internet users come and go in masses, which makes access management and preventing bandwidth abuse especially challenging. The anonymity of public users makes it especially challenging to retain user data for legal purposes. Without the right Internet access solution, there is no way for public areas or venues like hotels to provide high-quality but controlled Internet access, let alone generate revenue from Internet services.

The ZyXEL UAG5100 is a high-performance access gateway designed to manage guest access and generate revenue in public Internet access networks. Supporting up to 800 concurrent logins, the UAG5100 is perfect for medium-sized venues like hotels, convention centers or public libraries. It facilitates compliance with data retention laws, and ensures high-quality, always online Internet access with dual-WAN and per account bandwidth management capabilities. It also reduces hardware expenditure for BYOD deployments with a WLAN controller built-in.

Benefits

Deploy with confidence

The ZyXEL UAG5100 has the capacity to provide public Internet access to hundreds of users in medium-sized venues like hotels, libraries and convention centers. It supports 500 concurrent logins by default, and up to 800 via license upgrade. With dual-WAN support and per account bandwidth management, the UAG5100 maximizes Internet uptime and optimizes access quality to keep customers and visitors satisfied.

Generate revenue

The ZyXEL UAG5100 is designed with advanced billing, user authentication, and access control features that help organizations like hotels manage guest accounts, block unauthorized access, and generate revenue with Internet services. It facilitates monetization of networking investments by offering Internet access as a paid service, or a free service with limitations and premium when a purchase is made.

Reduce CAPEX and OPEX

The ZyXEL UAG5100 delivers Internet services with reduced capital and operational expenditures. Without additional hardware investments, the UAG5100 can scale up to 800 concurrent logins, and manage up to 32 APs with the integrated WLAN controller. The WLAN controller increases administrative efficiency with a centralized interface for AP management. The UAG5100 also offers ten (10) IPSec VPN tunnels that make it easy for MSPs to manage the gateway remotely.



UAG5100
Unified Access Gateway

Comply with regulations

To address information security concerns, businesses are sometimes required to retain public Internet access records for a certain amount time; and this can become a significant burden for the businesses without the right equipment. The ZyXEL UAG5100 has data retention functions that automatically retain Internet usage records for future auditing when required.

Model List

UAG5100 Unified Access Gateway



- 2 x GbE WAN (dual-WAN)
- 3 x GbE LAN/DMZ (P5 for PoE power input)
- USB interface for traffic log storage

SP350E Service Gateway Printer



- Buttons: 3
- Paper roll width: 58 (+0/-1) mm
- Interface: 10/100 Mbps RJ-45 port

Feature Introduction

Capacity and Performance

The UAG5100 is designed to provide controlled network access to hundreds of guests in medium-sized venues like hotels or public libraries. It supports 500 concurrent logins by default and up to 800 concurrent logins with license upgrade.

Billing System

The UAG5100 supports up to ten (10) pre-paid billing plans. Billing plans can be customized with varying bandwidth speeds, service duration, and level of payment. Credit card billing is also available via PayPal.

Dual-WAN

The UAG5100 provides non-stop Internet uptime with dual-WAN support. Dual-WAN works with two Ethernet WAN connections for active-active load balancing or active-passive failover.

WLAN Controller

The integrated WLAN controller supports CAPWAP, and enables centralized authentication and access management of multiple APs in the network. The UAG5100 can manage 16 APs by default, and up to 32 APs with license upgrade.

Data Retention

Deployed with a syslog server, the UAG5100 can automatically record user account information, MAC addresses, source and destination IPs, data volume and protocol type for future auditing requirements.

Account Management

The UAG5100 features a captive portal and a built-in account generator that can manage 300 static accounts and up to 4,000 dynamic accounts. External RADIUS servers and external portal page redirection is also supported by the UAG5100.

Printer and SMS Ticketing

The UAG5100 supports SMS ticketing via ViaNett and up to ten (10) SP350E printers. The SP350E enables one-click billing and account generation, and supports group ticket printout of up to 50 tickets at a time.

Bandwidth Management

The UAG5100 helps hotels ensure customer satisfaction with quality Internet services. It features per account bandwidth management to enforce equal bandwidth sharing and avoid bandwidth abuse.

PoE Powered Device

The UAG5100 features a special Powered Device (PD) design that enables it to be powered by an IEEE 802.3at PoE switch. Users can do without a power adapter by powering the UAG5100 via the P5 LAN/DMZ port (yellow).

Remote Management

The UAG5100 provides ten (10) IPSec VPN tunnels to make it easier and more efficient for MSPs (managed service providers) to remotely manage and service the UAG5100 installed at the customer premises.

Key Applications

Hotel Guest Access

- Users can connect two Ethernet WAN links to the UAG5100 to get higher uplink bandwidth with load balancing or WAN backup with failover
- The integrated WLAN controller enables users to centrally manage up to 32 APs with the UAG5100
- The SP350E printer can be installed at the reception desk to enable staff members to generate guest accounts with one click
- Managed service providers can remotely manage and service the UAG5100 with an IPsec VPN tunnel

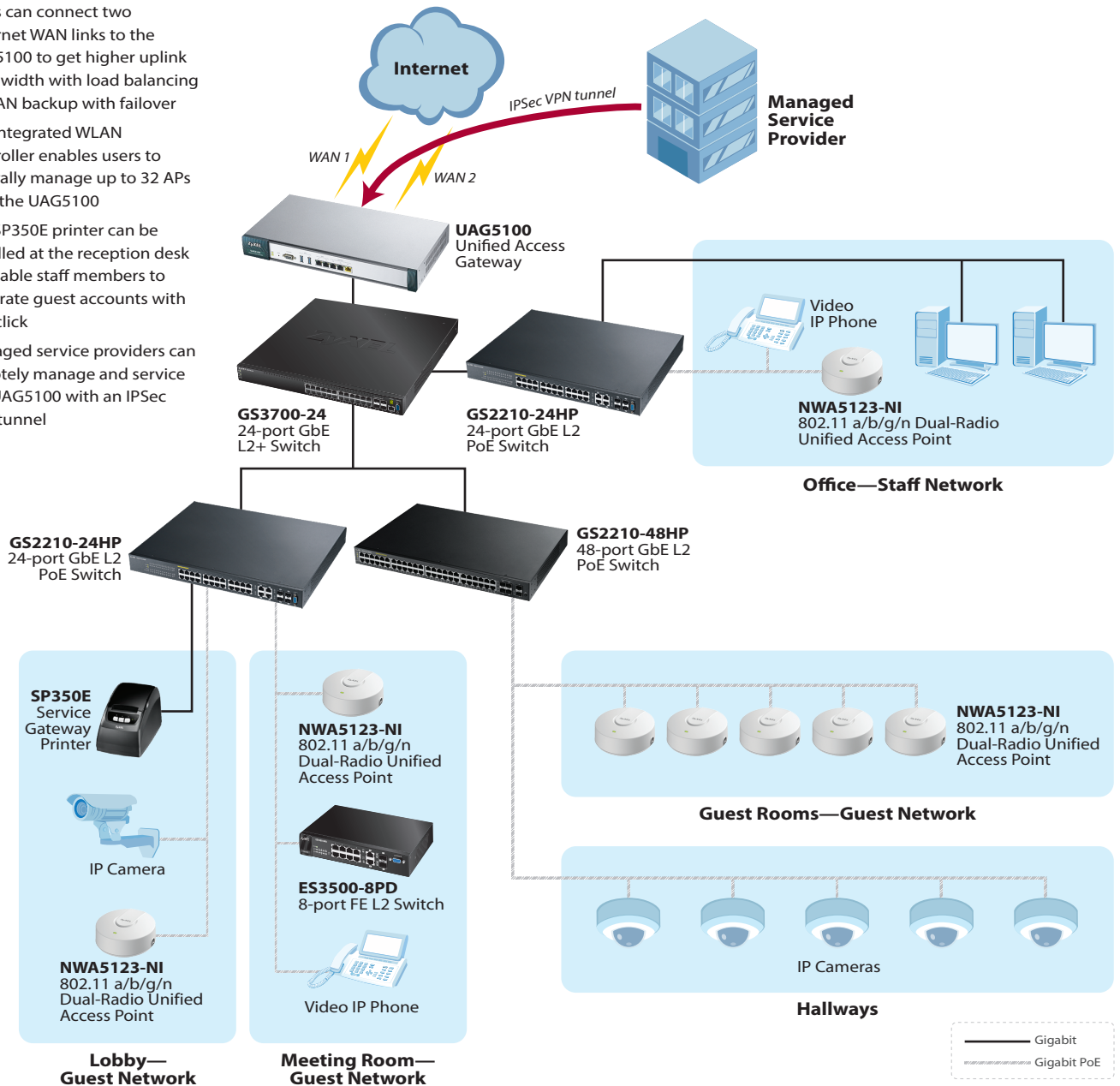

Specifications

Model		UAG5100
Hardware Specifications		
10/100/1000 Mbps RJ-45 ports		3 x LAN, 2 x WAN
USB ports		2
Ticket printer support		Yes (up to 10 printers)
System Capacity & Performance^{*1}		
Routing throughput (Mbps) ^{*2}		250
Concurrent logins (default/max.)		500/800
Max. concurrent sessions ^{*3}		80,000
DHCP pool size		4,096
Max. concurrent IPSec VPN tunnels		10
Built-in account generator	Static accounts	300
	Dynamic accounts	4,000
WLAN Management		
Built-in WLAN controller		Yes
Managed AP number (default/max.)		16/32
Power Requirements		
Power input		802.3at PoE Plus input; 100 - 240 V AC, 50/60 Hz, 0.6 A max.
Max. power consumption (watt)		25
Physical Specifications		
Item	Dimensions (WxDxH)(mm/in.)	382 x 205 x 44/15.04 x 8.07 x 1.73
	Weight (kg/lb.)	2.36/5.20
Packing	Dimensions (WxDxH)(mm/in.)	444 x 295 x 152/17.48 x 11.61 x 5.98
	Weight (kg/lb.)	3.7/8.16
Included accessories		<ul style="list-style-type: none"> • Power cord • Rack mounting kit
Environmental Specifications		
Operating environment	Temperature	0°C to 45°C/32°F to 113°F
	Humidity	10% to 90% (non-condensing)
Storage environment	Temperature	-40°C to 70°C/-40°F to 158°F
	Humidity	10% to 90% (non-condensing)
MTBF (hr)		71,032
Certifications		
EMC		FCC Part 15 (Class B), CE EMC (Class B), C-Tick (Class B), BSMI
Safety		LVD (EN60950-1), BSMI

Note:

*1: Actual performance may vary depending on network conditions and activated applications.

*2: Routing throughput measured using the industry standard Ixia IxLoad testing tool (1,460-byte TCP packets).

*3: Maximum sessions measured using the industry standard Ixia IxLoad testing tool.

Features Set

Networking

- Dual-WAN load balancing, failover and fallback
- Universal Plug and Play (UPnP)
- IP Plug and Play (iPnP)
- NAT/PAT
- Static routing and policy routing
- DHCP client/server/relay
- HTTP proxy support
- SMTP redirection
- VPN 1-to-1 mapping
- VPN pass-through
- WAN client: static, DHCP, PPPoE, PPTP
- Tagged VLAN (802.1Q)
- DDNS

Security

- Stateful packet inspection firewall
- 10-channel IPSec VPN support (site-to-site)
- L2 isolation
- User-aware security policy
- Session limit
- IP pass-through (white list)

AAA & Billing

- Web-based authentication
- User agreement login
- External RADIUS support
- Secondary RADIUS server support
- Built-in billing system:
 - Time-to-finish accounting mode
 - Accumulation accounting mode
- 10 customizable billing profiles
- Built-in account generator
- Multiple logins with pre-configured accounts
- Bandwidth management (per account)
- Credit card billing via PayPal
- Thermal printer support (up to 10)
- SMS ticketing support with ViaNett

Marketing

- Advertisement link
- Walled garden
- Login page redirection
- Portal page
- Customizable login page
- Customizable information window
- Customizable user agreement page

System Management

- Administrator access: WAN and LAN
- Web management (HTTP/HTTPS)
- Secure administrator IP address
- SNMP v2c (MIB-II)
- Configuration backup and restoration
- Role-based administration (Admin, guest operator)
- Command line interface (console/web console/SSH)

Monitoring and Reporting

- Email log
- Syslog: account, IP, MAC, traffic & protocol (data retention)
- Session list
- Account list
- Billing report
- DHCP client list
- Printer IP discovery support

WLAN Management

- ZyXEL AP Controller (APC) 1.0 compliant
- Client RSSI threshold to prevent sticky clients
- IEEE 802.1x authentication
- Captive portal Web authentication
- Customizable captive portal page
- RADIUS authentication
- Wi-Fi Multimedia (WMM) wireless QoS
- CAPWAP discovery protocol

Accessories

Model	Feature
SP350E Service Gateway Printer 	<ul style="list-style-type: none"> • Buttons: 3 • Paper roll width: 58 (+0/-1) mm • Interface: 10/100 Mbps RJ-45 port • Power input: 12 V DC, 5 A max. • Item dimensions (WxDxH): 176 x 111 x 114 mm (6.93" x 4.37" x 4.49") • Item weight: 0.8 kg (1.76 lb.)

License

Item	Model	Description
Managed AP scalability license	LIC-EAP	Increases the amount of supported managed APs by 16
User scalability license	LIC-SX	Increases the amount of supported concurrent logins by 300

Access Point Compatibility List

Series	NWA5120 Series Unified Access Point	NWA5000 Series Managed Access Point	NWA3000-N Series Unified Pro Access Point
Models	NWA5123-NI NWA5121-NI NWA5121-N	NWA5160N NWA5560-N NWA5550-N	NWA3160-N NWA3560-N NWA3550-N
Functions			
Central management	Yes	Yes	Yes
Auto provisioning	Yes	Yes	Yes
Data forwarding	Local bridge	Local bridge	Local bridge



For more product information, visit us on the web at www.ZyXEL.com



Copyright © 2014 ZyXEL Communications Corp. All rights reserved. ZyXEL, ZyXEL logo are registered trademarks of ZyXEL Communications Corp. All other brands, product names, or trademarks mentioned are the property of their respective owners. All specifications are subject to change without notice.

