

ClearOne®

CHAT® 60 | Personal Speakerphone for Skype™



Quick Start Guide



TABLE OF CONTENTS

CONFIGURING THE CHAT DEVICE	1
CHAT 60 FEATURES	2
CONNECTING TO A COMPUTER.....	3
USING THE CHAT 60 WITH SKYPE	4
SPECIFICATIONS AND REQUIREMENTS.....	5
System Requirements.....	5
Connections.....	5
Audio.....	5
Power.....	5
Controls.....	5
Environmental.....	5
Processing.....	5
Mechanical.....	5
Compliance.....	5
Model Numbers.....	5

Configuring the CHAT Device

The CHAT 60 can be used right out of the box and there's no software to download or install if it is to be used only with a PC.

If the CHAT device requires a firmware update, follow the instructions in the specific CHAT User's Manual to setup and configure the CHAT device.

The latest version of the software and CHAT User's Manual can be found on the ClearOne Website at:

<http://www.clearone.com/support/downloads.php?content=main>

Scroll down the page to the CHAT 60/160 section and click the relevant links.

Follow the instructions in the manual to install and configure the CHAT device.

CHAT 60 Features



Connecting to a Computer

The following describes how to connect the CHAT 60 to a PC.

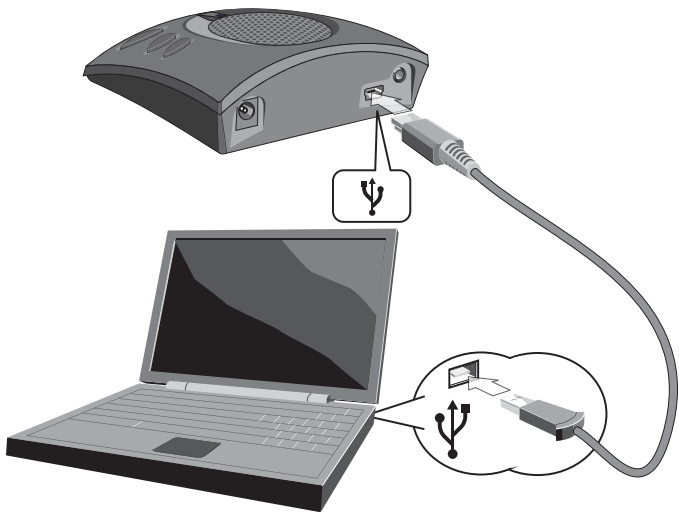

Using the CHAT 60 with Skype

With your CHAT device plugged in to your computer:

1. Launch Skype from your Start - Programs tool bar (or desktop shortcut)
2. Log in to Skype (or create a new account)
3. A dialog box at the top of the page will alert you that a new audio device was found and will list your CHAT unit. Select OK.
4. Test your device with the Echo / Sound Test Service.
5. Enjoy!

Important! CHAT devices are designed to work on flat, stable surfaces with no obstructions. For best results, do not hold or move the device while in use.

NOTE: When you plug a CHAT speakerphone into your PC or laptop it will become the default audio device for Windows. More information can be found on the Microsoft Website:

<http://support.microsoft.com/kb/936004> (Vista)

<http://support.microsoft.com/kb/935708> (XP)

Specifications and Requirements

System Requirements

Windows XP, Vista or 7

Connections

USB:

Version 2.0 Compatible

Type: Mini-B Female

3.5mm Line I/O Mini-Plug:

Tip: Output, Ring: Input, Sleeve: Ground

Frequency Response:

20 Hz - 20 kHz +/- 1 dB

Maximum Input Level: +6 dBu

Input Impedance: 10 k Ω

Output Impedance: 50 Ω

Audio

Speaker

Bandwidth: 220 Hz - 14 kHz

Max Output Level:

80 dB SPL @ 1 foot (0.30 meter)

Microphone

Bandwidth: 50 Hz - 7.75 kHz

Power

USB: 5 VDC @ 500 mA Maximum

External: Input: 100-240 VAC, Output: 7 VDC @ 500 mA, Tip: Power, Ring: Ground

Controls

Volume Up, Volume Down, Microphone Mute

Environmental

Operating Temperature:

41 - 104° F (5 - 40° C)

Processing

Full Duplex

Acoustic Echo Cancellation (AEC)

Noise Cancellation (NC)

Line Echo Cancellation (LEC) - Selectable

Automatic Level Control (ALC)

Mechanical

Dimensions (W x D x H):

3.8" x 4.1" x 1.8"

(9.7 cm x 10.4 cm x 4.6 cm)

Weight:

0.55 lbs (0.25 kg)

Compliance

RoHS

REACH

FCC Class B Part 15

ICES-003

UL Listed

CE Listed

Model Numbers

910-159-251 CHAT 60

Software Downloads and Product Support

Updates, User Manuals and product information for the CHAT 60 are available at:

<http://CHAT60.ClearOne.com>

The CHAT 60 is specifically designed to be used with Skype. However, the product can also be used with other devices such as enterprise telephones and other applications such as VoIP softphones, web conferencing, instant messaging and PC-based gaming. For more information and to download applicable software, access:

<http://skype.ClearOne.com>

For more information about Skype and to download the Skype software, access:

<http://www.skype.com>

Technical support for your CHAT product is available Monday through Friday, 9:00 AM to 8:00 PM, EST at:

1-800-283-5936

Or via email:

tech.support@clearone.com

© 2010 ClearOne All rights reserved. Information in this document is subject to change without notice.

Other product names may be registered trademarks of their respective owners who do not necessarily endorse ClearOne or ClearOne's products in the United States and/or other countries.

ClearOne Document: 800-156-251 Revision 2.1 November 2010.