

FEKA GL 750 - 1000

SUBMERSIBLE PUMPS



TECHNICAL DATA

Operating range:

from 3 to 28,5 m³/h with head up to 14 metres.

Pumped liquid:

slightly loaded water, generally for use in the presence of domestic or residential sewage waste, compatibly with the construction materials.

Free passage: 46 mm.

Liquid temperature range: from 0 °C to +35 °C for domestic use.

Maximum immersion depth: 7 metres.

Motor protection class: IP 68.

Insulation class: F.

Standard voltage: 220-240 V - 50Hz single-phase.
380-415 V - 50Hz three-phase.

Power cable: H07RN-F, standard length 10 metres.

Installation: free, vertical position.

Continuous duty with completely submerged pump.

APPLICATIONS

Submersible electric pumps, generally suitable for domestic or residential use, for lifting slightly loaded and sewage water with solid matter with size up to 46 mm.

CONSTRUCTION FEATURES OF THE PUMP

ENGJL 200 cast iron motor body and hydraulic body. Fibreglass reinforced Nylon upper cover and impeller.
Silicon/Silicon mechanical seal.

CONSTRUCTION FEATURES OF THE MOTOR

Dry, asynchronous and waterproof motor, cooled by the surrounding liquid.

Continuous S1 duty with completely submerged pump.

Rotor mounted on permanently lubricated ball bearings, oversized to ensure long-term reliability and extended lifetime.

Capacitor housed in the wiring compartment under the upper cover for the single-phase version.

Number of poles: 2

Max starts/hour: 20

MATERIALS

N.	PARTS*	MATERIALS
1	POWER INPUT CABLE	H07RN-F
2	UPPER COVER	GLASS REINFORCED NYLON
3	MOTOR BODY	EN GJL 200 CAST IRON
4	MOTOR SHAFT	AISI 420
5	OR	NBR
6	BEARING FLANGE	EN GJL 200 CAST IRON
7	MECHANICAL SEAL	PUMP: SILICON - SILICON
8	IMPELLER	GLASS REINFORCED NYLON
9	HYDRAULIC BODY	EN GJL 200 CAST IRON

* In contact with the liquid

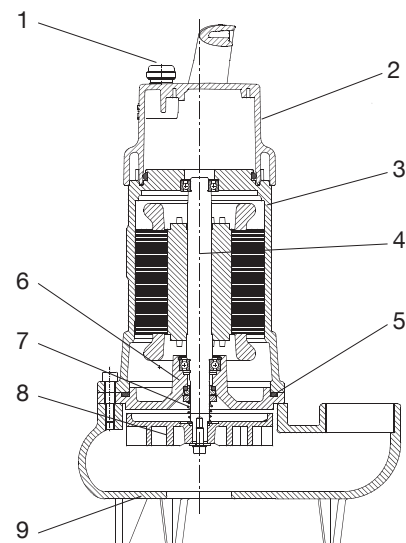

PERFORMANCE RANGE

The performance curves are based on kinematic viscosity values = 1 mm²/s and density equal to 1000 kg/m³. Curve tolerance according to ISO 9906.

GRAPHIC SELECTION TABLE

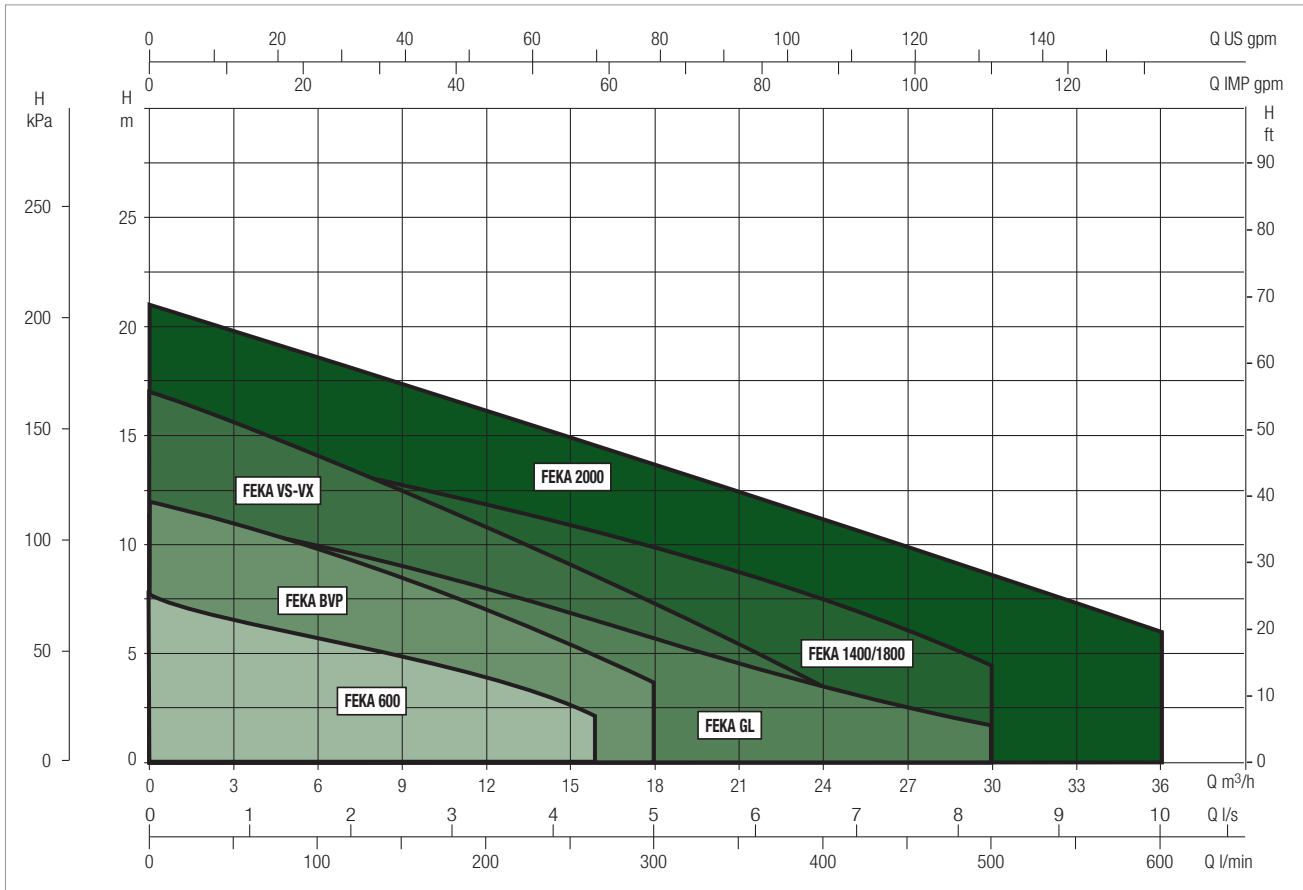

SELECTION TABLE - FEKA GL

MODEL	Q= m ³ /h	0	3	6	9	12	15	18	24	30	36
	Q=l/min	0	50	100	150	200	250	300	400	500	600
FEKA GL 750 M	H	7.2	6.8	6.2	5.5	4.8	4.1	3.3	1.6		
FEKA GL 1000 M	(M)	11.5	10.8	10	9.1	8	7	5.8	3.5	1.8	

FEKA GL 750 - 1000 - SUBMERSIBLE PUMPS FOR LIFTING WASTE WATER

Liquid temperature range: from 0 °C to +35 °C for domestic use

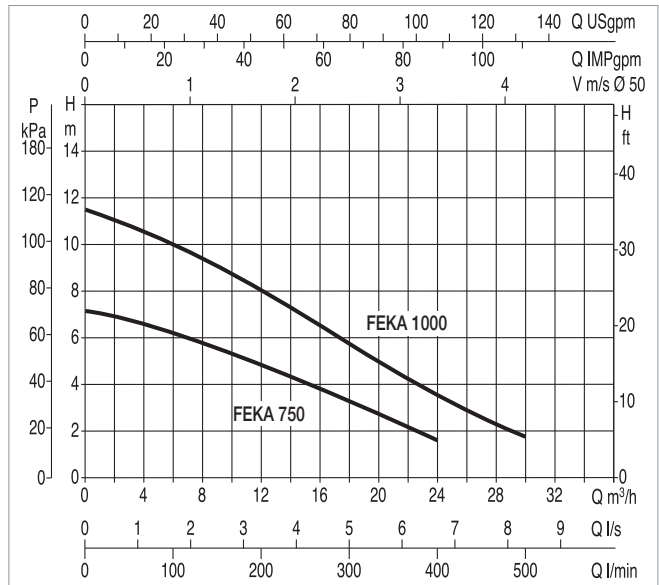
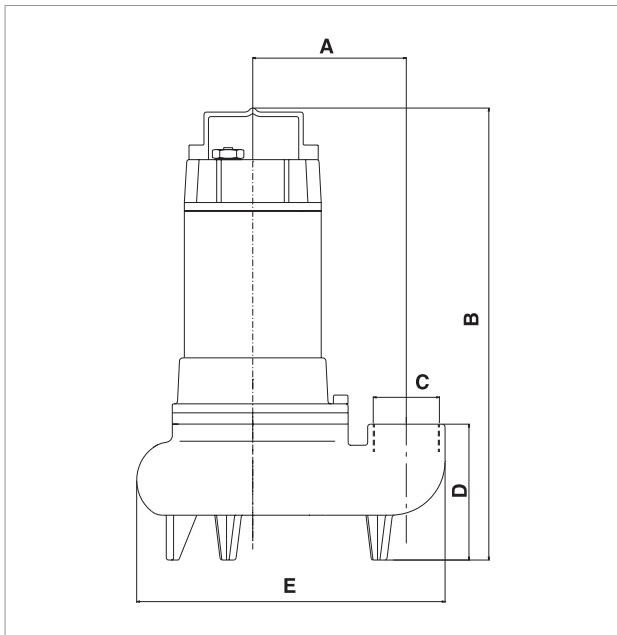

The performance curves are based on kinematic viscosity values = 1 mm²/s and density equal to 1000 kg/m³. Curve tolerance according to ISO 9906.

MODEL	ELECTRICAL DATA						
	POWER INPUT 50 Hz	P1 MAX kW	P2 NOMINAL		In A	CAPACITOR	
			kW	HP		µF	Vc
FEKA GL 750 M-A	1 x 230V ~	0.9	0.6	0.8	4.1	16	450
FEKA GL 750 M-NA	1 x 230V ~	0.9	0.6	0.8	4.1	16	450
FEKA GL 1000 M-A	1 x 230V ~	1.6	1.1	1.5	7	25	450
FEKA GL 1000 M-NA	1 x 230V ~	1.6	1.1	1.5	7	25	450

MODEL	A	B	C DNM	D	E	DNM GAS	FREE PASSAGE mm	PACKING DIMENSIONS			VOLUME (m³)	WEIGHT kg
								L/A	L/B	H		
FEKA GL 750 M-A	137	412	2" F	120	275	2"	46	250	270	470	0.032	18
FEKA GL 750 M-NA	137	412	2" F	120	275	2"	46	250	270	470	0.032	18
FEKA GL 1000 M-A	137	412	2" F	120	275	2"	46	250	270	470	0.032	19
FEKA GL 1000 M-NA	137	412	2" F	120	275	2"	46	250	270	470	0.032	19